

SAGE BANNER DISPLAY STAND

(Only for selected models)

STEP 1

Remove the cover at the top of the pole
(All of our sage accessories use the channels on the pole to attach the accessories).

(a) Attach the clear plastic clips to both ends of the banner and slide banner and plastic clips onto the banner holder.

(b) Close ends of banner holder.

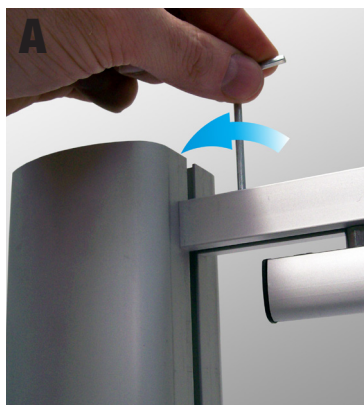

STEP 2

To Attach the banner holder slide the fitting along the channel in the display pole. Adjust to appropriate height and tighten.

(a) Use allen key provided to tighten banner holder in place.

