

ASSEMBLY INSTRUCTIONS

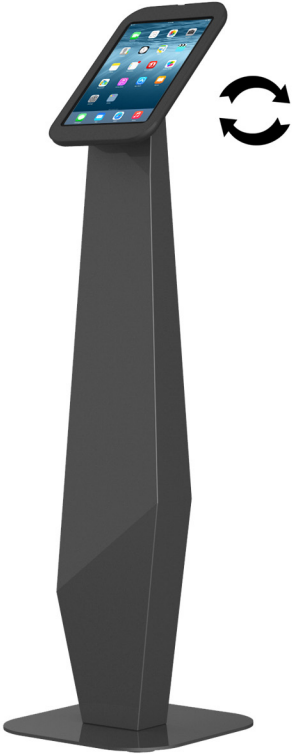

NOTE: iPad and charging cable are not included.

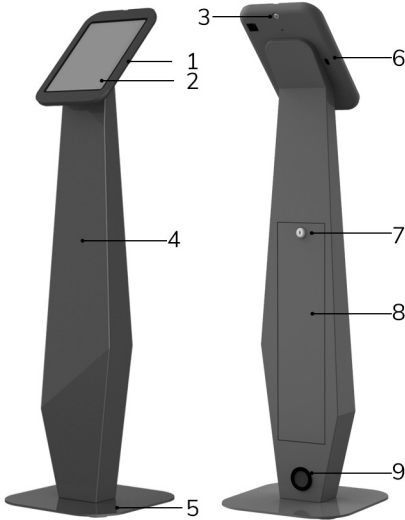

- | | |
|-------------------|-----------------------|
| 1. Front Cover | 2. iPad(not included) |
| 3. Lock | 4. Stand |
| 5. Base | 6. Back Cover |
| 7. Rear Door Lock | 8. Rear Door |
| 9. Rubber Grommet | |

1. Attach EVA foam furniture pads to the metal base. Assemble the metal base to the bottom of the stand.

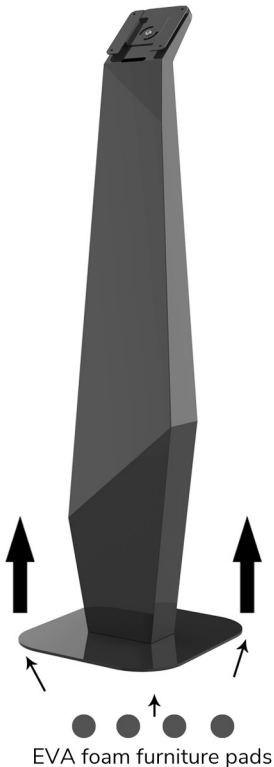

2. Attach the iPad enclosure to the top of the stand.
The enclosure can be rotated to either portrait or landscape orientation.

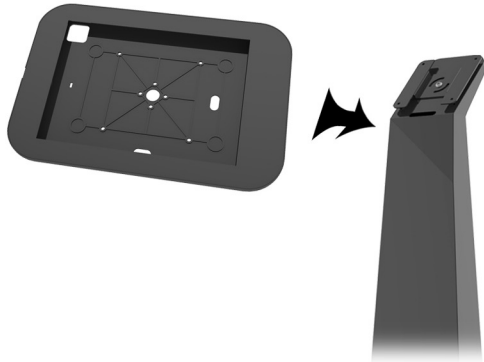

3. Unlock the cover and take out the panel diagonally.
Please choose to use different silicone and EVA pads according to your iPad size. (Silicone & EVA pads are in tablet enclosure box)

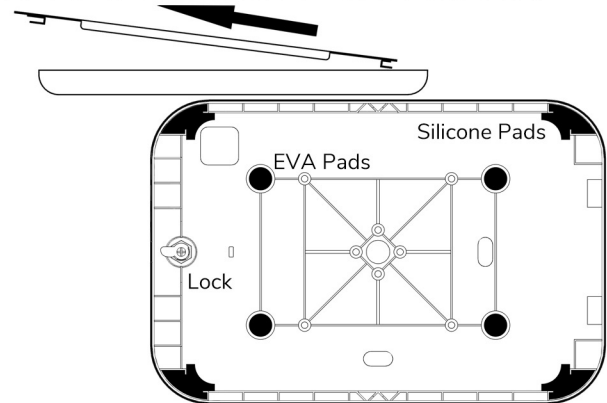

4. Carefully place your iPad inside the enclosure.
Connect the charging cable with the iPad. Then close the cover and securely lock it to the enclosure.



5. Please take out USB port after connected power cable to iPad.
Close the back door and lock it.
The assembly is finished.

