

Stand-Off Installation Dimensions

Please locate the SKU of the product you are installing in the table below then use the corresponding dimensions to mark the fastening points on the wall to which you are installing the stand-offs

SKU	Horizontal (H)	Vertical (V)
WMAPOSTA4P	239mm	210mm
WMAPOSTA4L	329mm	120mm
WMAPOSTA3P	329mm	330mm
WMAPOSTA3L	451mm	210mm
WMAPOSTA2P	449mm	505mm
WMAPOSTA2L	624mm	330mm
WMAPOSTA1P	624mm	755mm
WMAPOSTA1L	874mm	505mm



Installation Instructions



1. Mark out the position of the stand-offs as per the table above and screw the wall brackets in place using the screws and wall anchors provided

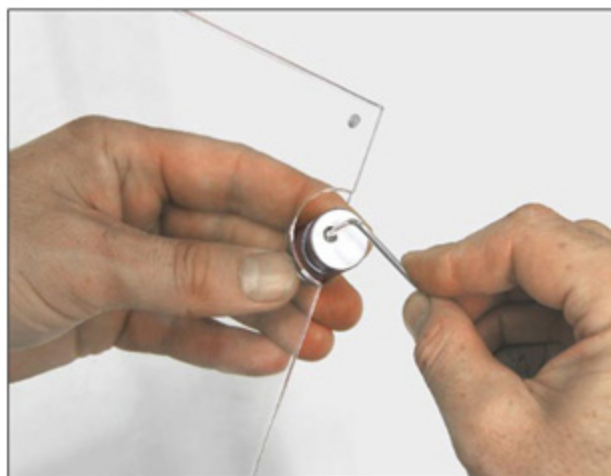

2. Slide the cut-out areas of the acrylic into the slots on the stand-offs. Centre the stand-offs in the cut-out area and loosely fasten the grub screw as shown

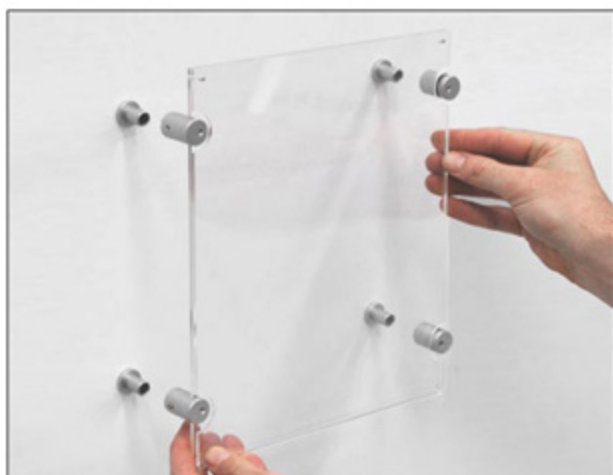

3. Once the upper stand-offs are assembled to the acrylic, slide the assembly onto the wall pieces. Fine tune the position of the upper pieces as required



4. Finally, tighten both grub screws on each of the upper stand-offs to fasten the sign in place