

# Heavy Duty TV Wall Mount Instructions

SKU: TVWM110



<b>Product Specifications</b>	3
<b>Caution</b>	4
<b>Parts list</b>	5
<b>1. Disassembling the Panel</b>	6
<b>2. Installing Panel onto Concrete Wall</b>	6
<b>3. Installing Panel onto Wood Studs</b>	7
<b>4. TV Installtation</b>	8
<b>5. Check the Mount is Firmly Mounted on the Wall</b>	9
<b>6. Installing TV Panel onto Mount</b>	9
<b>7. Tilt Angle Adjustment</b>	10
<b>8. Leveling Angle Adjustment</b>	10

# Product Specifications

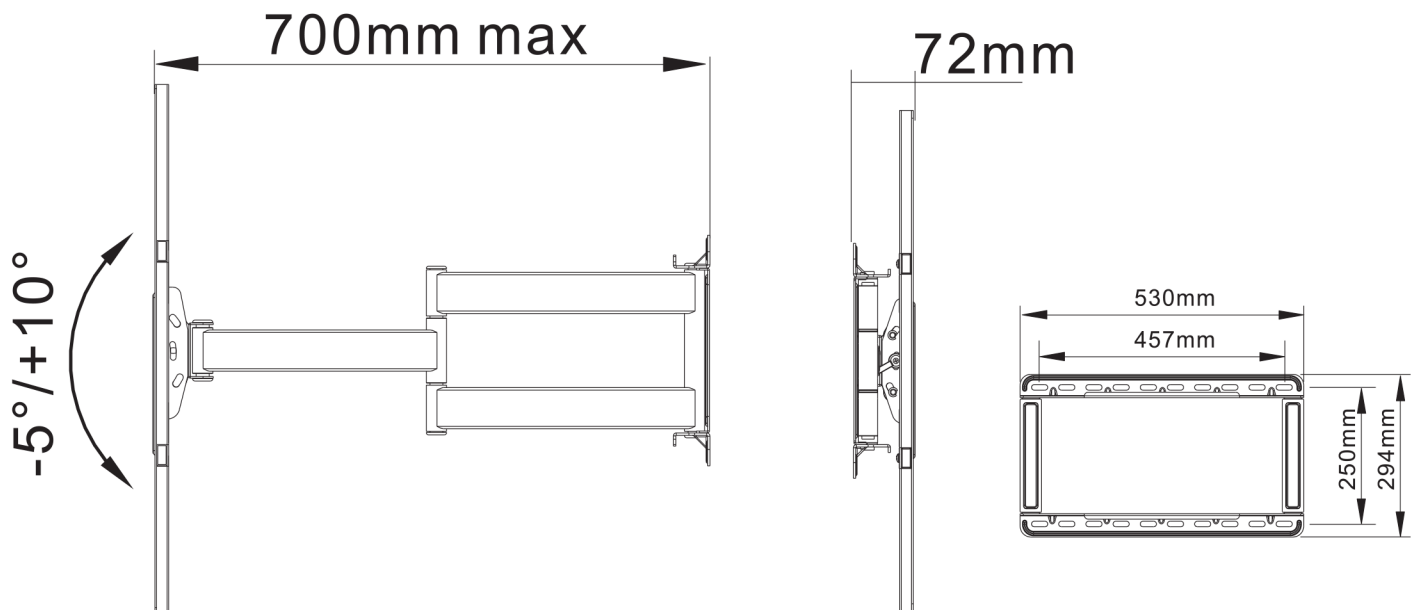
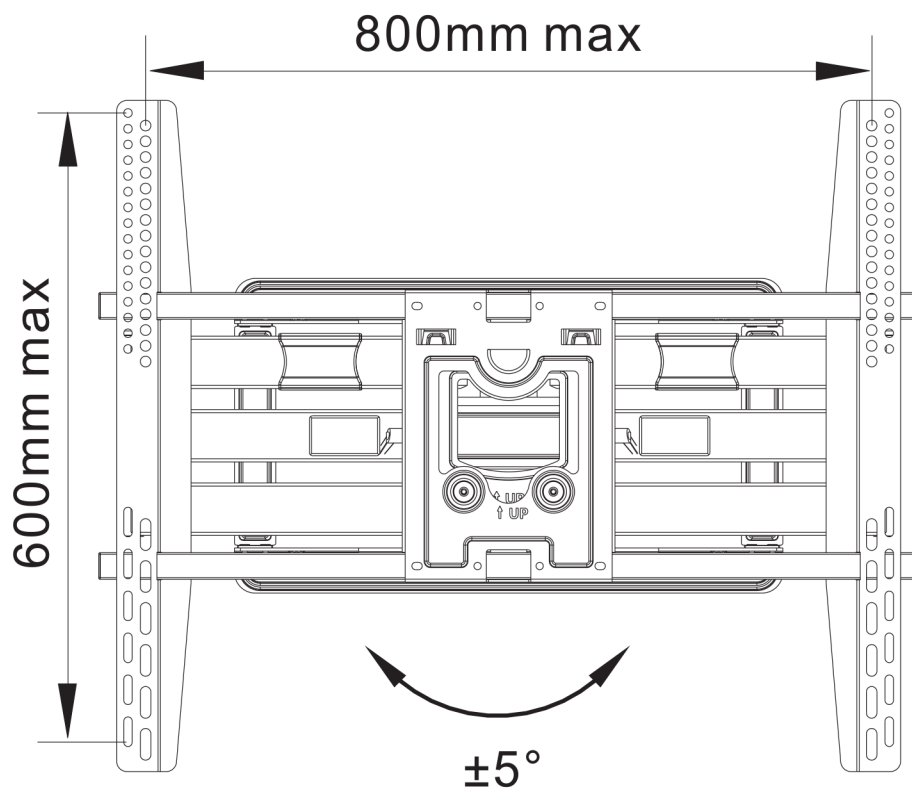

VESA:400×400-800×600mm

**LOAD CAPACITY**  
**200 LBS/90.9KG MAX**

## Pay attention when use

- 1.Products must be installed by professionals.
- 2.If you do not understand the instructions or have any concerns or questions, please contact a qualified local installer.
- 3.Do not install or assemble if the product or hardware is damaged or missing, if you require replacement parts, please contact you local distributor for assistance.
- 4.This product fits most 75"-110" LCD /plasma screen; maximum weight of LCD /plasma screen: 90.9 kg/200lbs.
- 5.This product has been designed for use on a vertical wall constructed of wood studs (minimum 2" x 4" inch(51x102mm) or masonry (solid concrete).
- 6.For safe installation, the wall you are mounting to must support minimum 3 times the weight of the total load (the mount, the TV and all accessories).
- 7.Do not use this product for any other application than original designed.
- 8.This product contain moving parts, please use with caution.
- 9.When installing flat panel display, please do not damage electrical wiring or power source.
- 10.Installation and routing of monitor cables on the monitor bracket must comply with electro-technical regulations.
- 11.Importantly, mains- and data-cables must be secured against twisting and squeezing or shearing.
- 12.The manufacturer will bear no responsibility to the vertical wall of mounting, or incidental or consequential damages arising thereof.
- 13.The manufacturer disclaims any liability for the modifications, improper installation, or installation over the specified weight range. The manufacturer will not be liable for any damages arising out of the use of , or inability to use, the product.



# Parts List

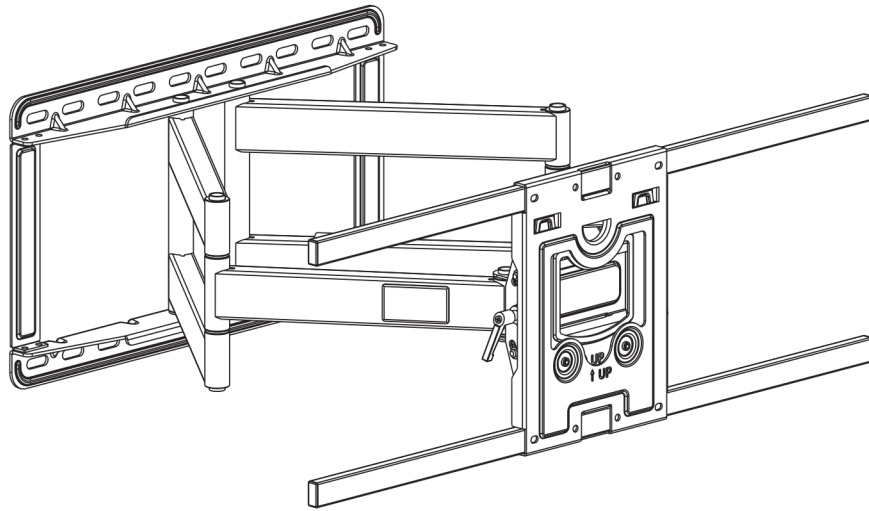

a

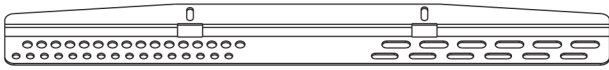

b

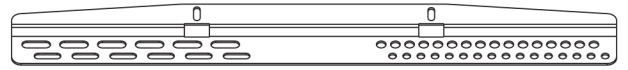

A



4pcs  
M5×25

B



4pcs  
M6×25

C



4pcs  
M8×25

D



4pcs  
Φ16×Φ6.2×1.5

E



4pcs  
Φ27×Φ18×H14

F



6pcs  
Φ20×Φ10.2×2.0

G

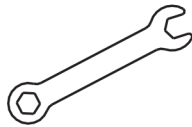

1pcs  
10mm

H



6pcs  
3/8"×88mm

I

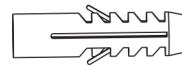

6pcs  
Φ14×Φ10×70

J



4pcs  
Φ16×Φ8.2×1.5

## Manual



Tightening  
Direction



Loosening  
Direction



Phillips  
Screwdriver

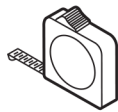

Meter Ruler



Adjustment



By Hand



Allen key



⊕ Tightening  
⊖ Loosening

## 1. Disassembling the Panel

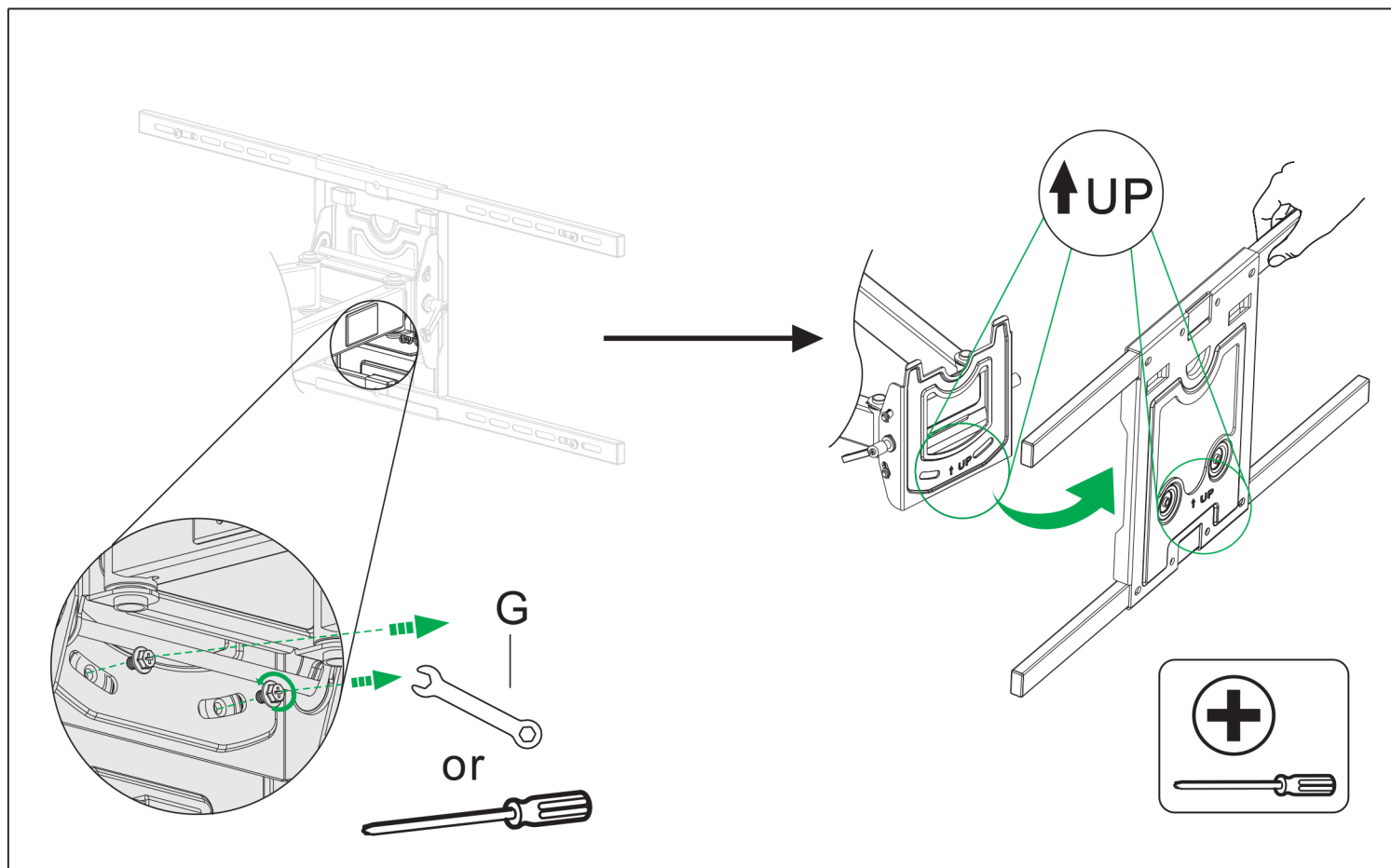

## 2. Installing Panel onto Concrete Wall

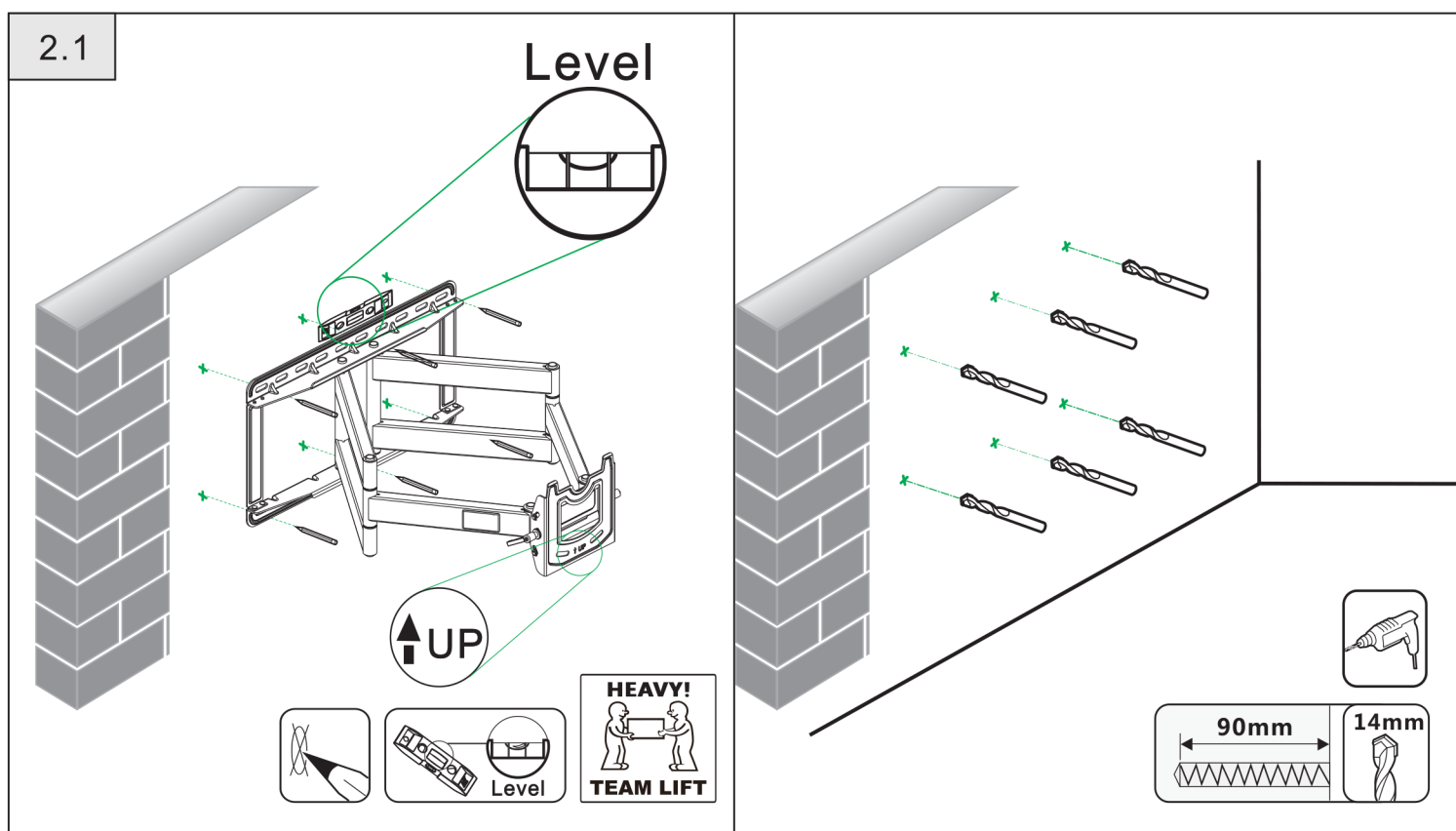

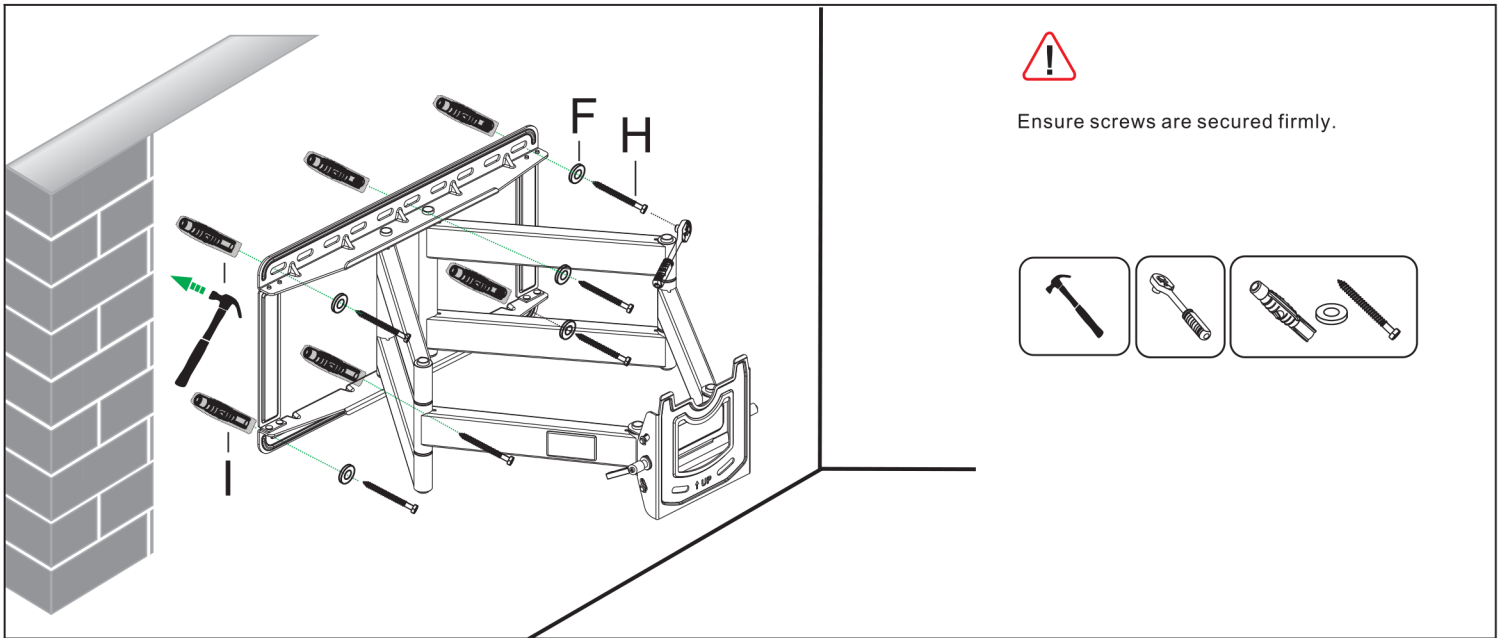

### 3. Installing Panel onto Wood Studs

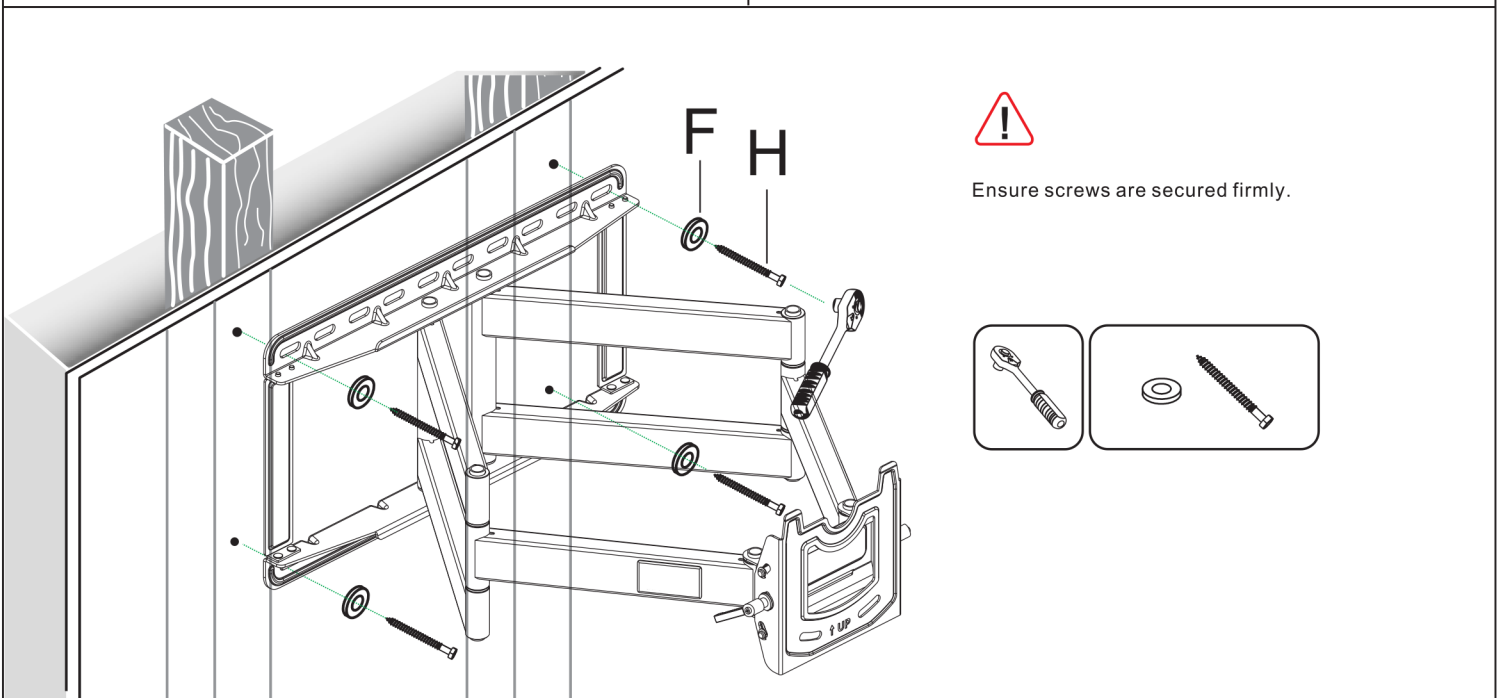
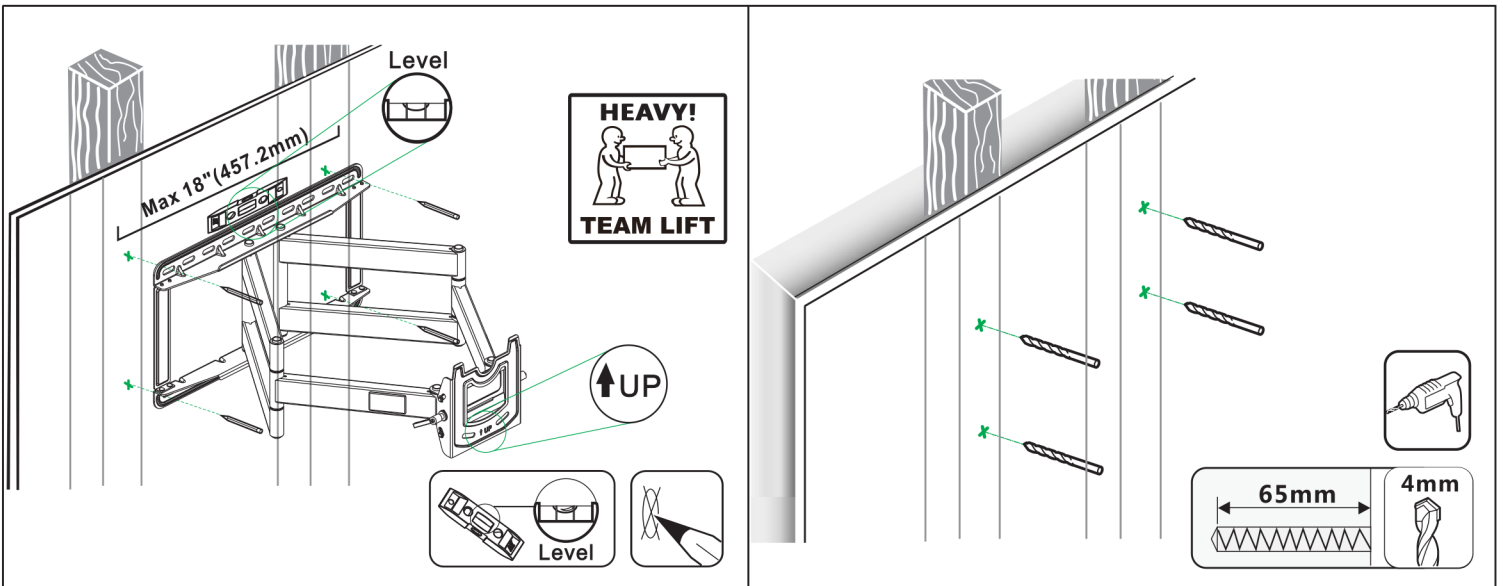

## 4. TV Installation

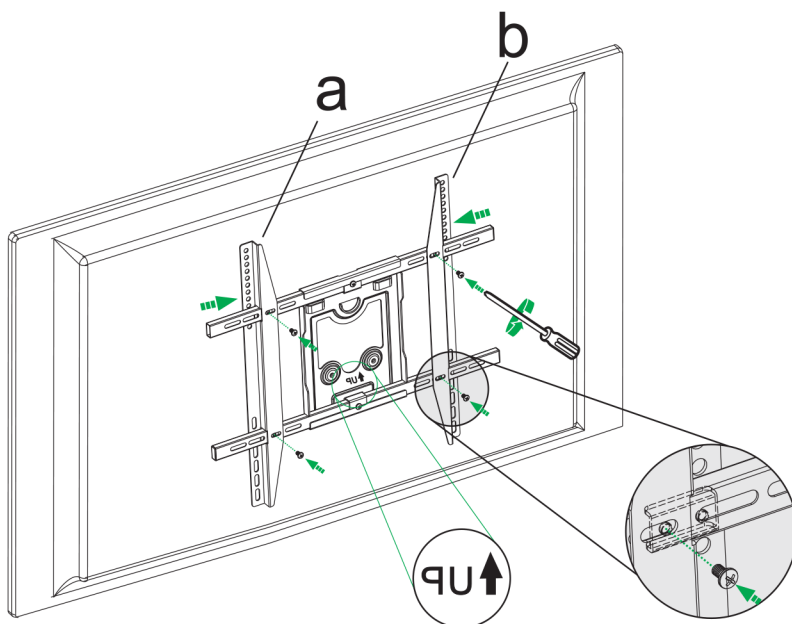
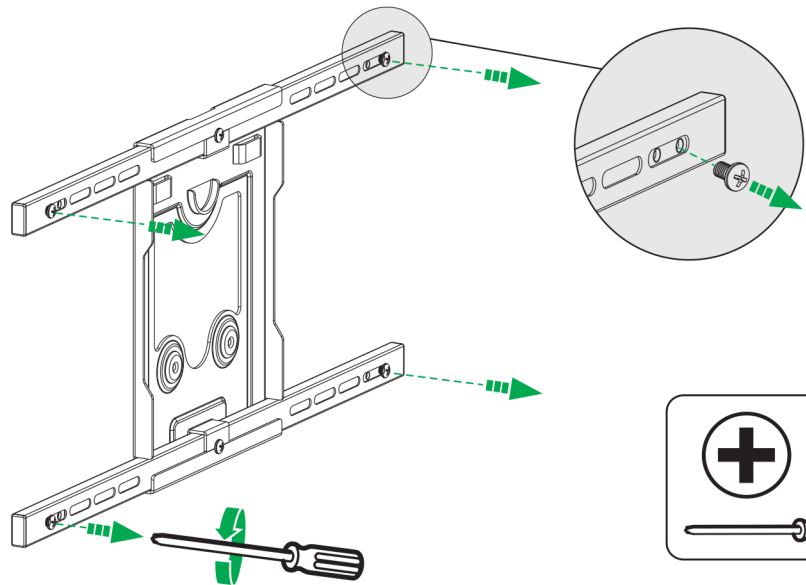
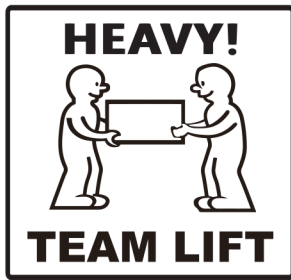

Ensure screws are secured firmly.

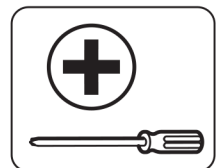

VESA:400x400mm~800x600mm

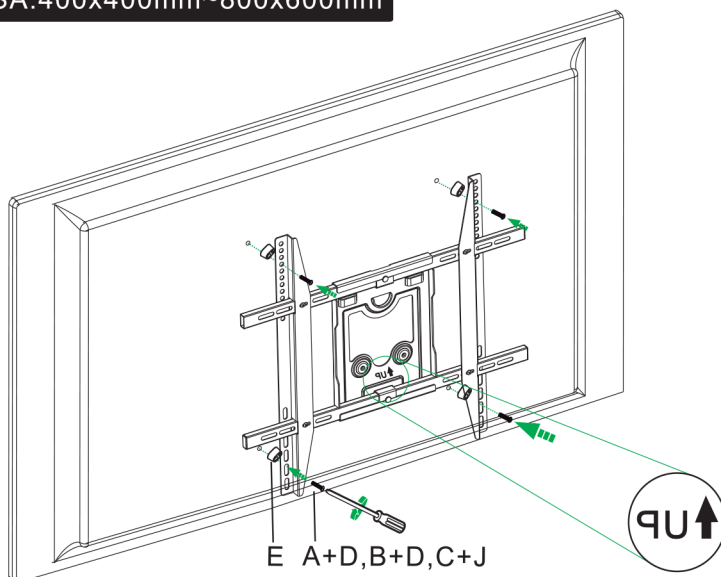

Ensure screws are secured firmly.

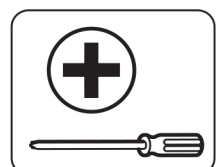

## 5. Check the Mount is Firmly Mounted on the Wall

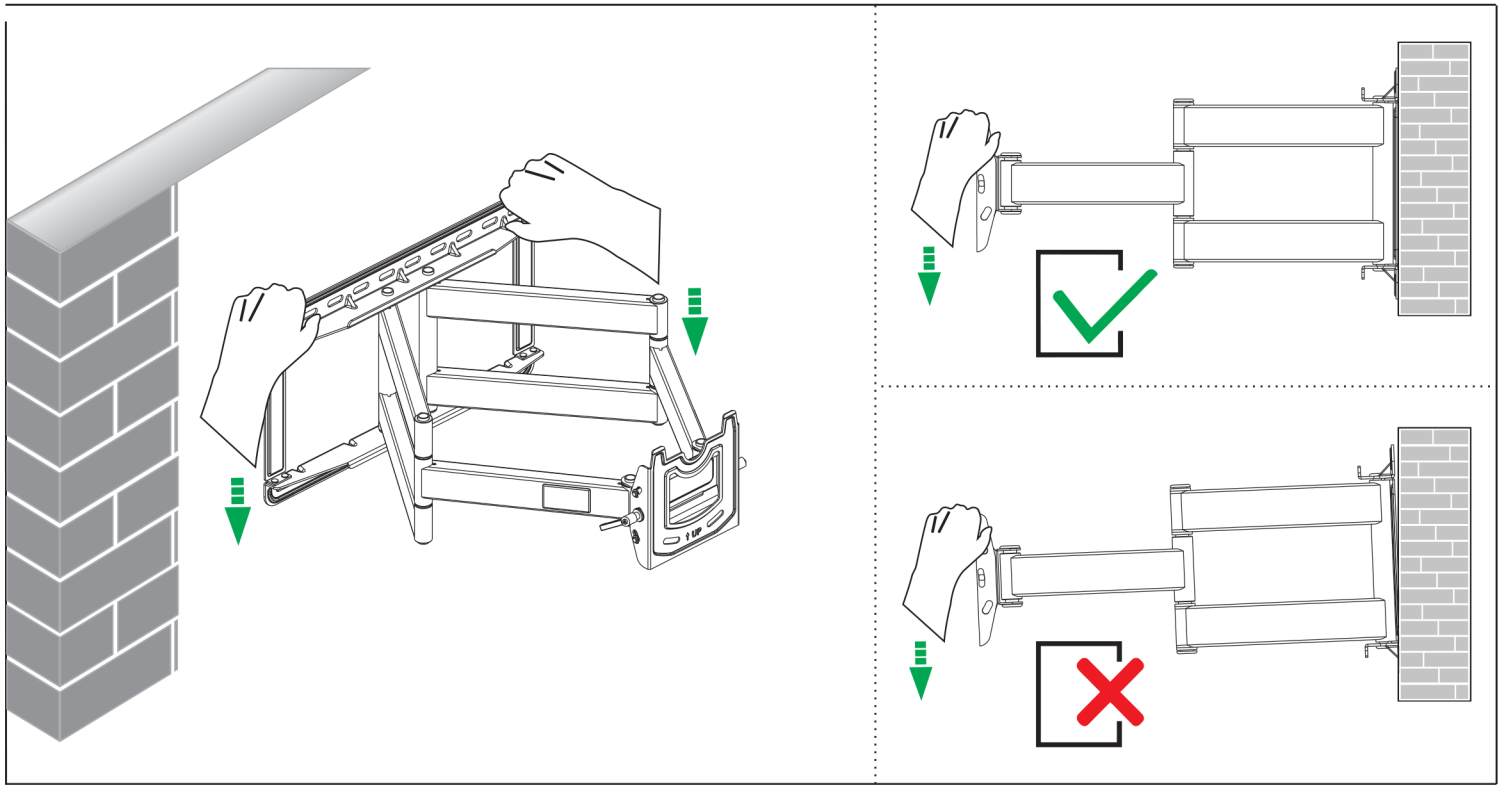

## 6. Installing TV Panel onto Mount

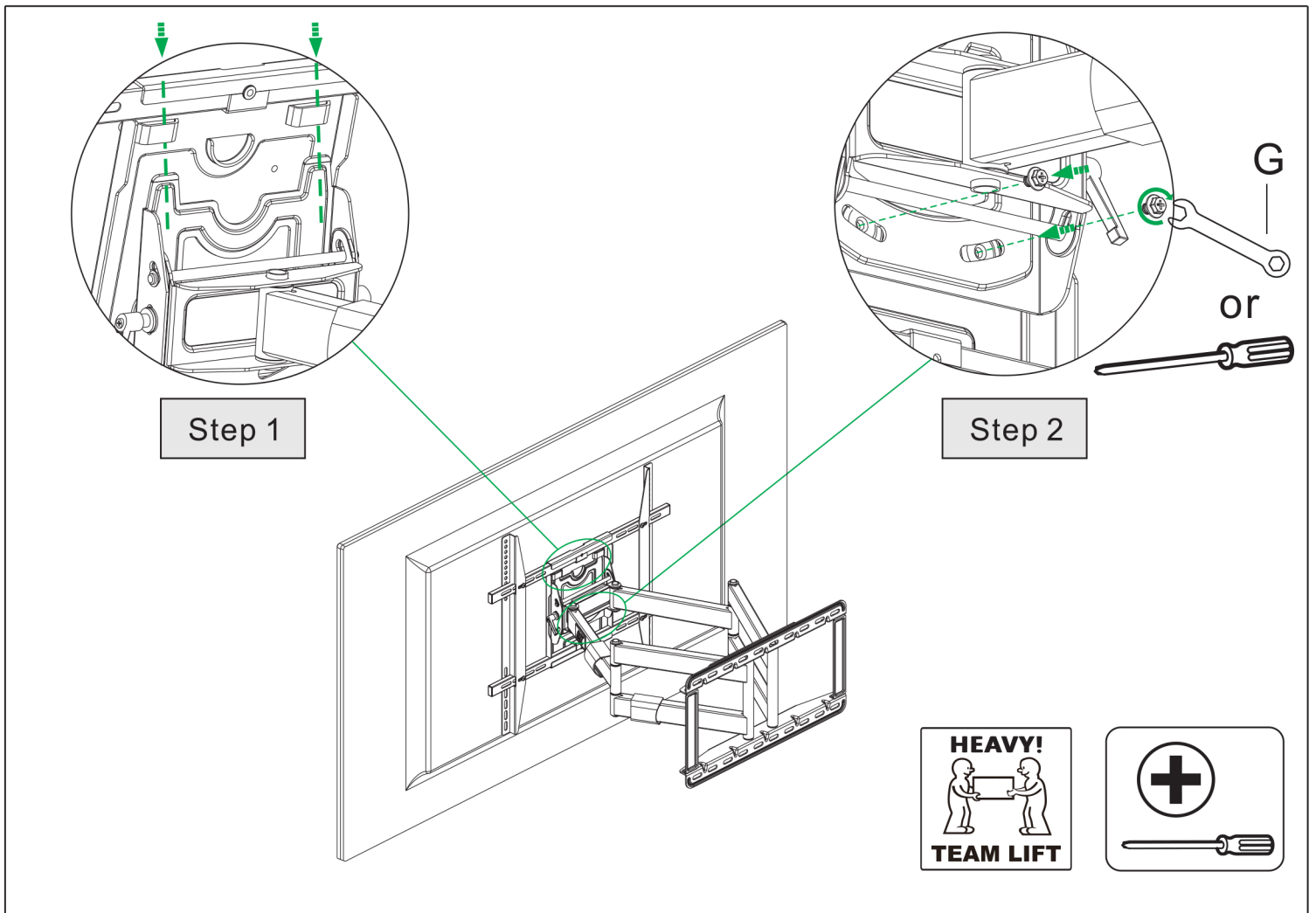

## 7. Tilt Angle Adjustment

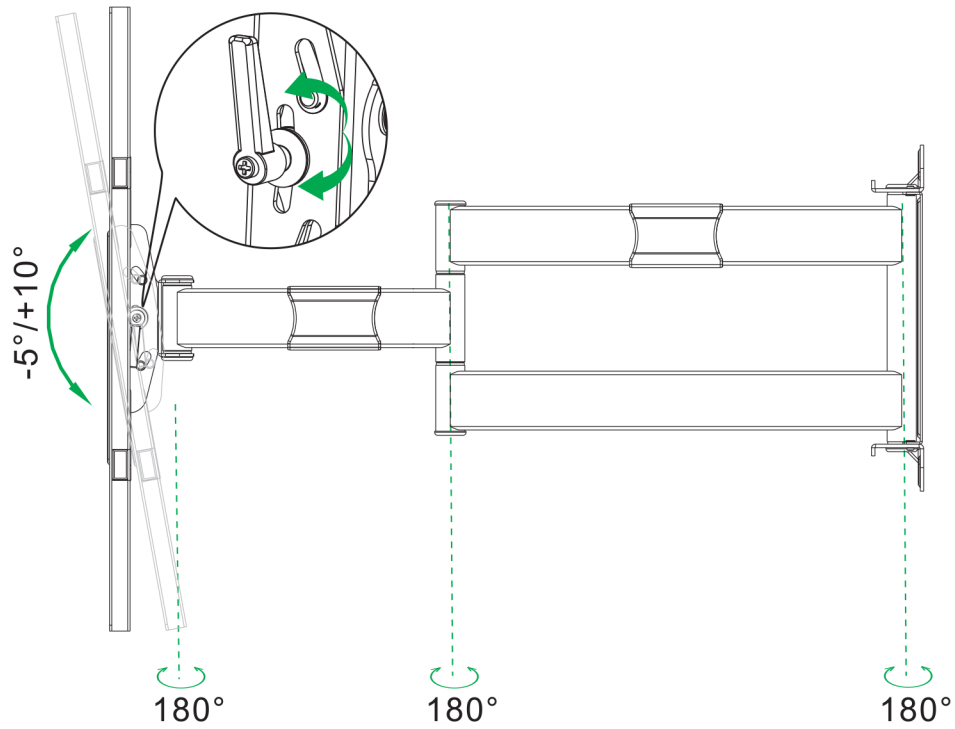

## 8. Leveling Angle Adjustment

