

# Portable Counter with Inner Shelves Set Up Instruction

SKU: PECDUO

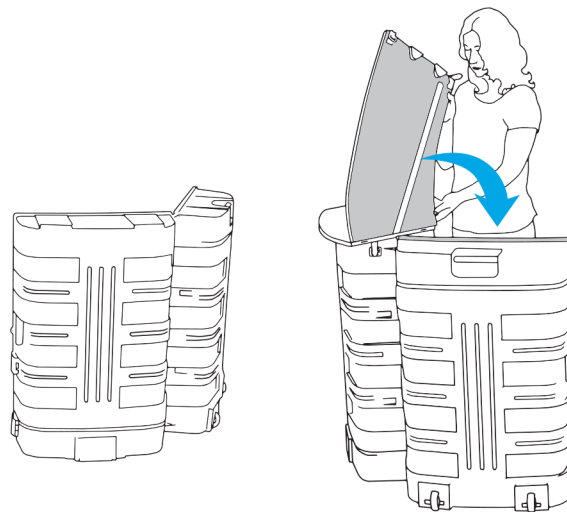

- A. 2x Shipping Case
- B. Shelves & Storage Pouch
- C. Countertop & Storage Pouch
- D. PVC Kick Plate
- E. Hook & Loop Strip\* (Used for attaching printed vinyl)



1. Stand shipping case upright, unlock the 4 clips and open the case. Lift up countertop latches. Align underside groove with shipping case edge and rest in place.

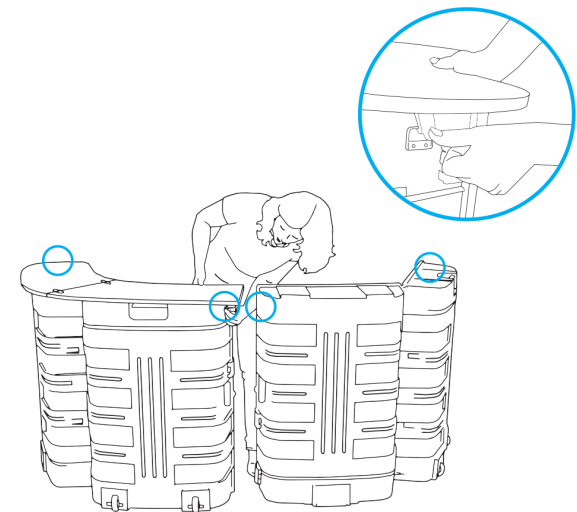

2. Secure 4 underside latches to hooks attached to the side of the case. Repeat step 1 & 2 on the other side.

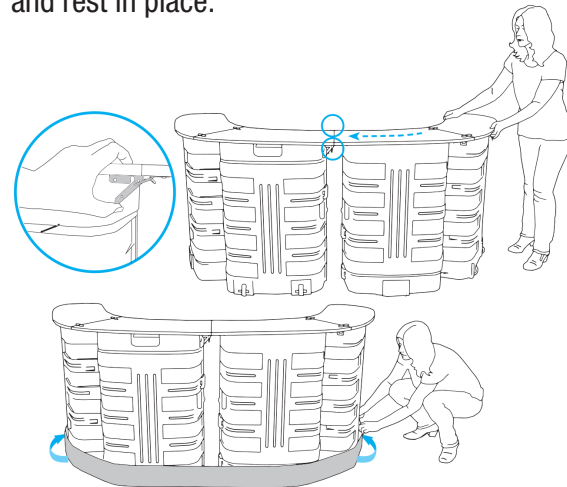

3. Move 2 assembled cases next to each other and join them by locking the latches underneath the countertops. Wrap PVC kickplate around the bottom to cover wheels. Attach the hook and loop strips on the ends of the kickplate to the corresponding pieces inside the case.

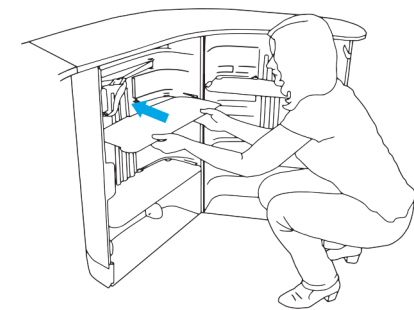

4. Insert shelves at the designated slots inside the case.