

TVON009SV / TVON009BK - Assembly Instructions

Thank you for purchasing the portable monitor stand. This monitor stand comes with VESA brackets designed to accomodate TV's from 15" to 26" diagonal weighing up to 15KG. A digital photo frame stand, that includes a 90° tilt, TV angle can be adjusted according to your require. No additional tools are required for assembly.

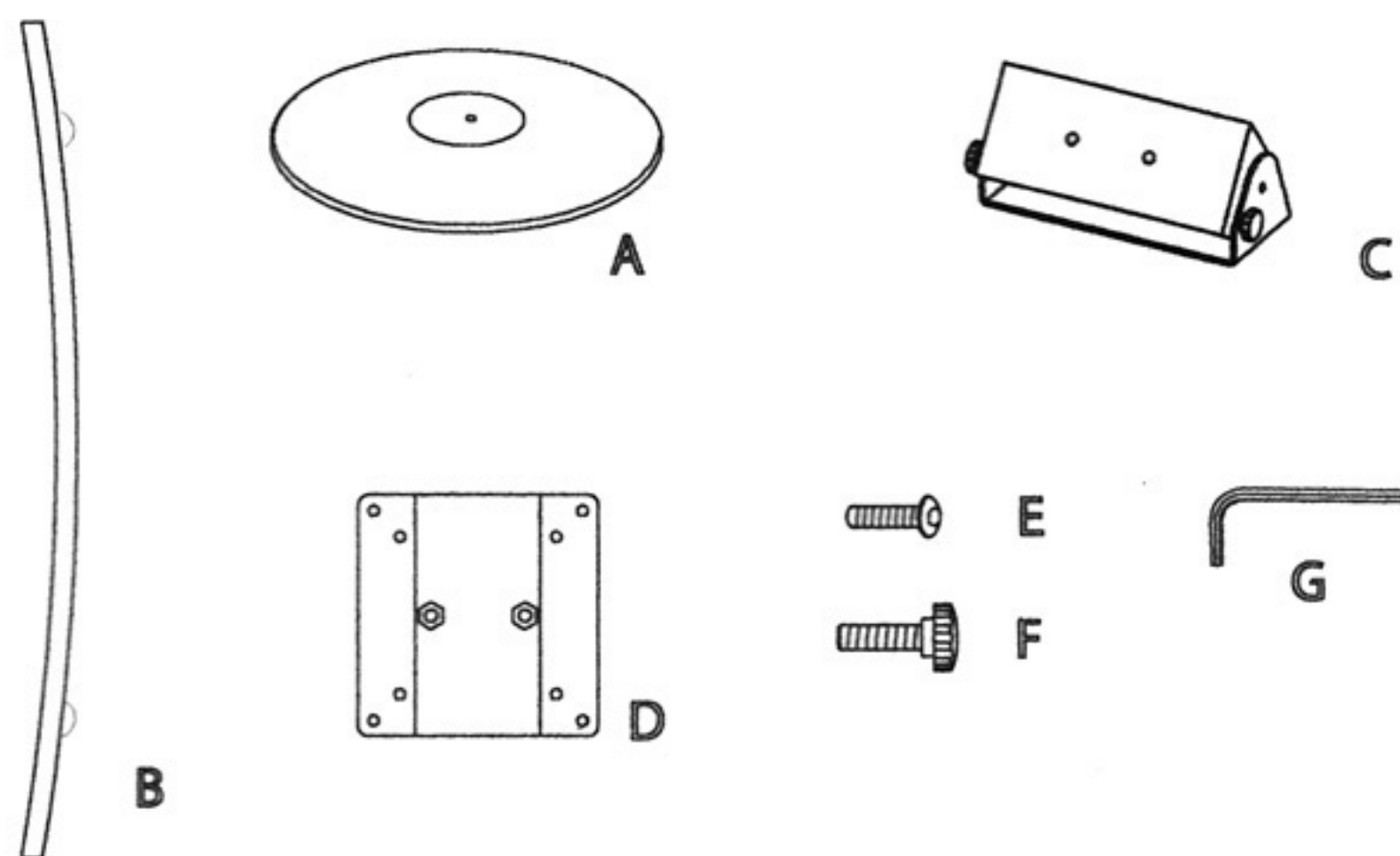

Part	ID	Qty
Base	A	1
curved column	B	1
Tilting Brackets	C	1
100x100 VESA	D	1
Screw M6x18 mm	E	2
Hand driven screw	F	1
Allen Key	G	1
Carry Bag	Not Shown	1

Step 1.

Base(A) align the curved column(B) screw holes and twist screws tightly.

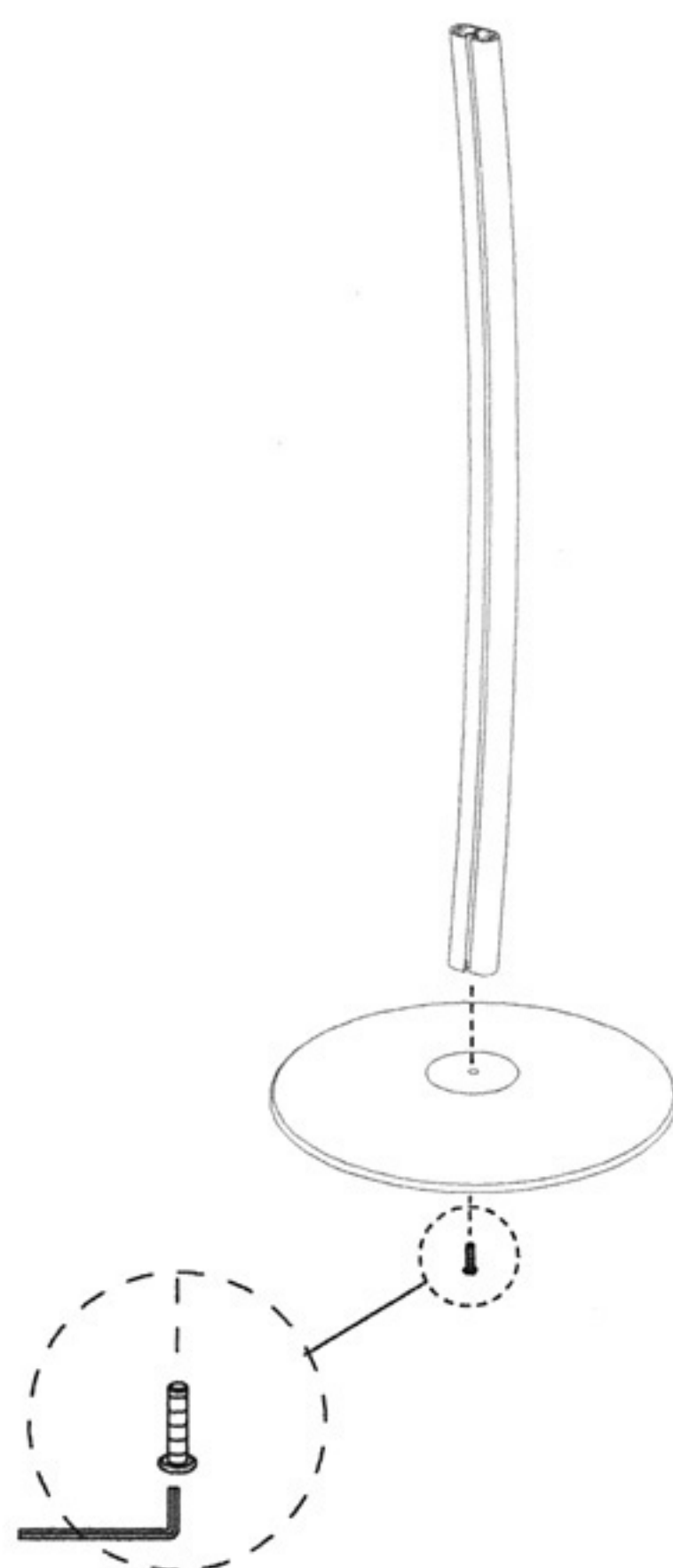

Step 2.

Curved column(B) align the Tilting VESA Brackets(C) screw holes and twist screws tightly.

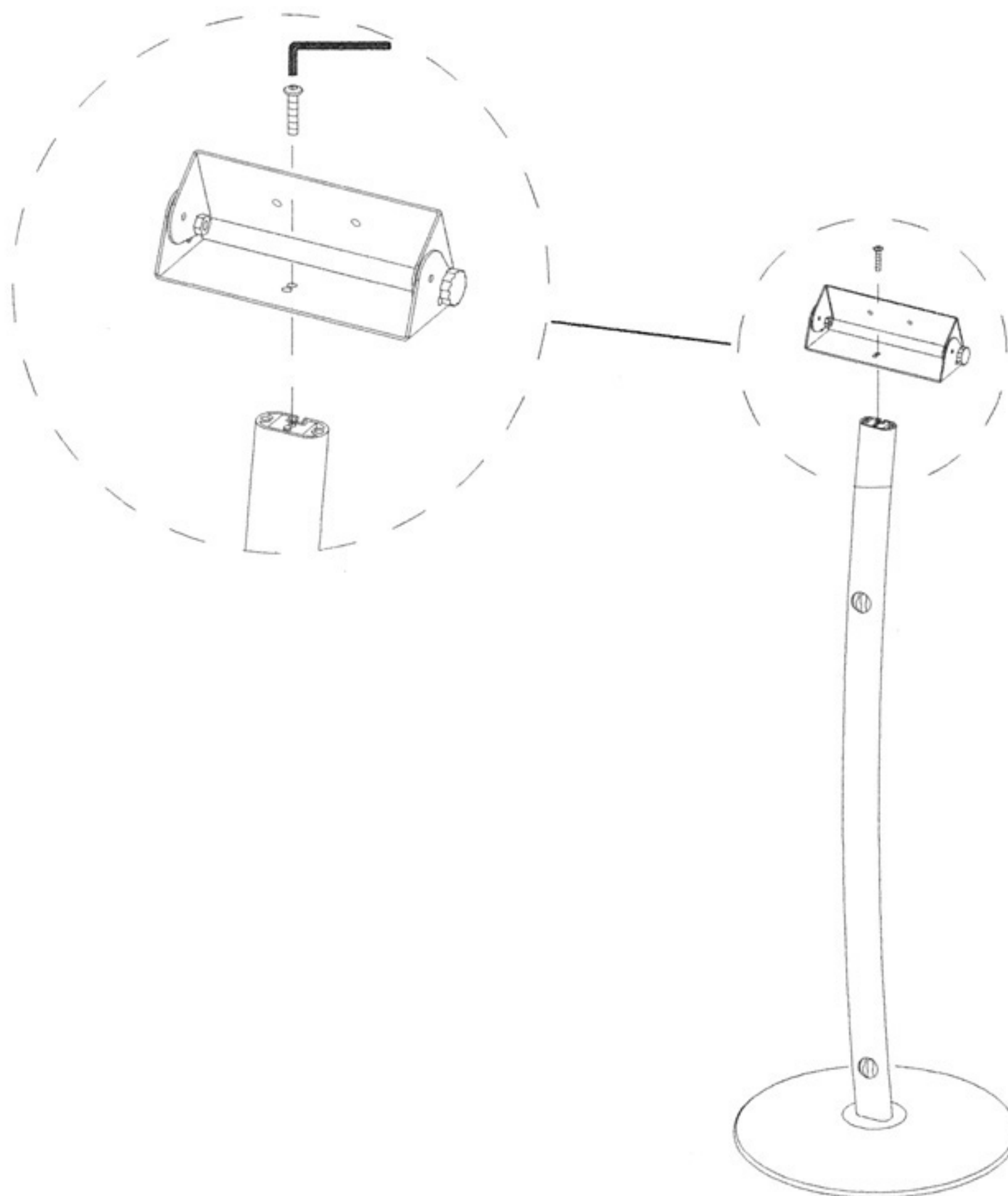

Assembly Instruction

Step 3.

Align the VESA bracket(D) keyholes with the screw holes on the back of TV, use the Allen key to tighten with the M4 screws provided. Once the TV assembled with VESA bracket, align the back of the Tilting VESA Brackets(C) keyholes, and simply tighten with hand driven screws.

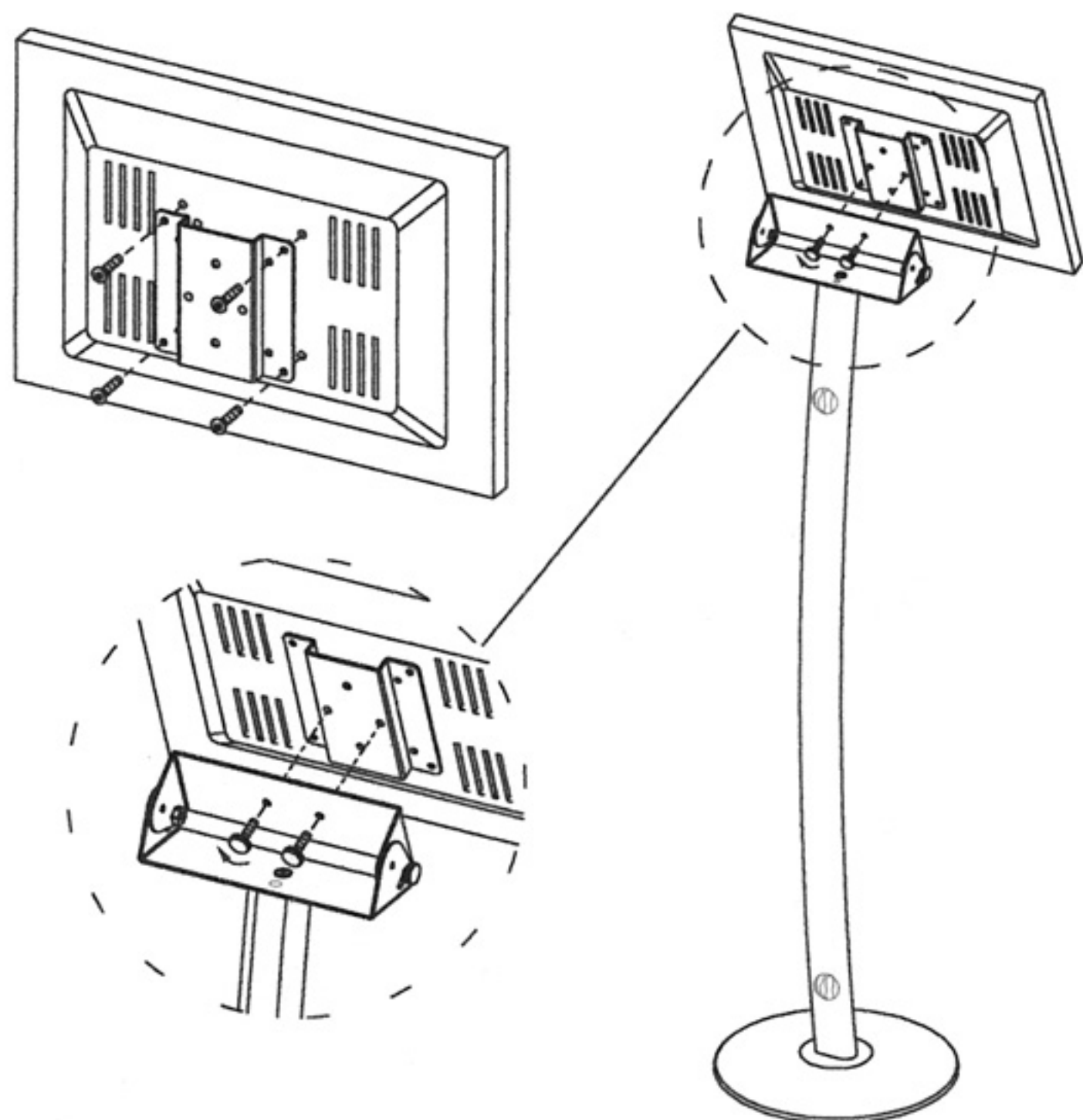

Step 4.

TV angle can be adjusted according to your require, and simply tighten with hand driven screws.

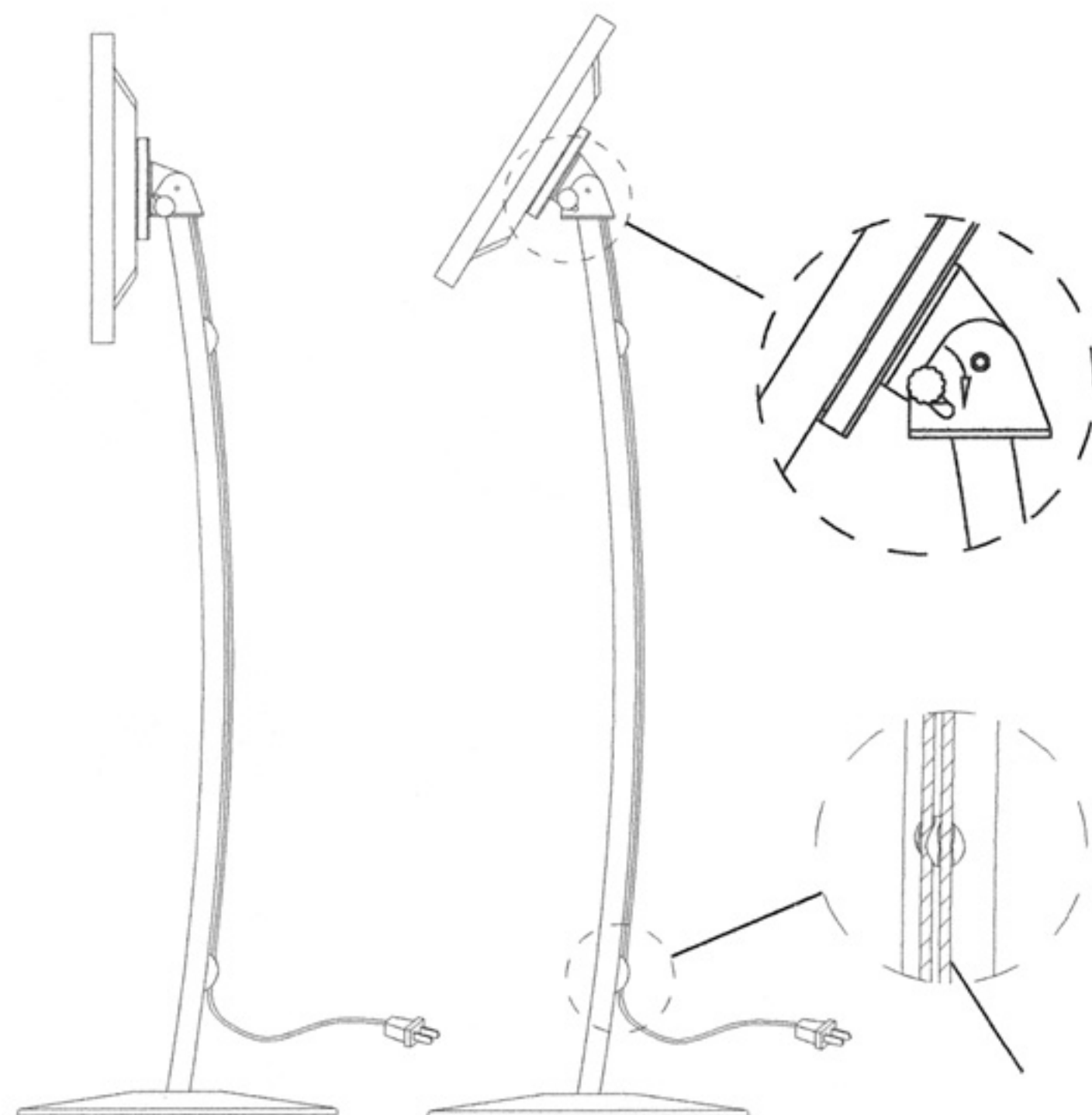

The back of the column was kept hidden wires

Step 5.

